

Wrap Reinforcing Mesh

Protective Wrap Lapped  
Into Sill Flashing

Sealant With Closed Cell  
Backer Rod Around Entire  
Perimeter Of Window

Corrosion Resistant  
Blocking

Place Weeps In  
Sealant at Sill Every  
12" (305 mm)

Slope EIFS Below Sill

Sill Pan Flashing With  
Turned Up Sides And  
Water Tight Seams

Sealant

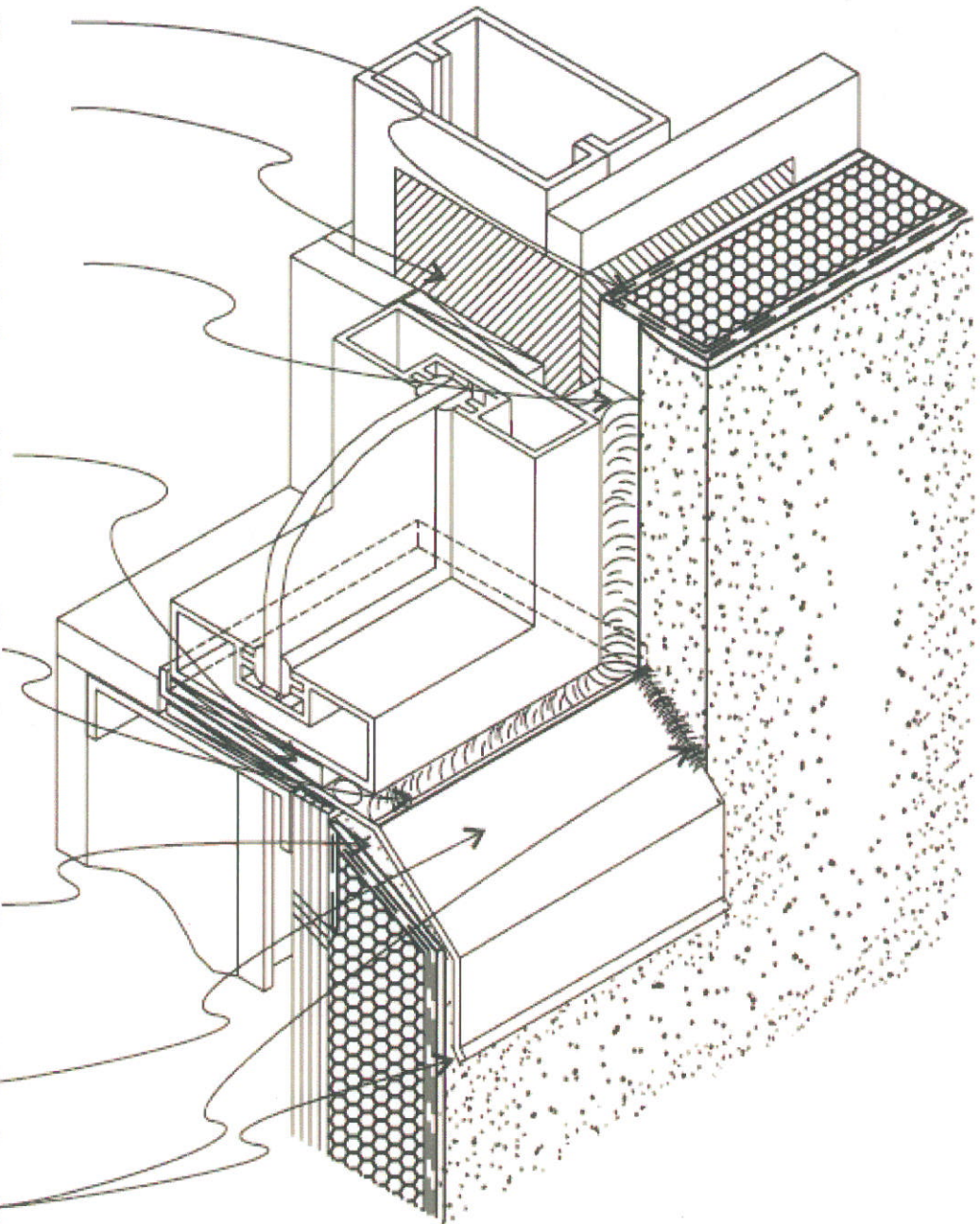

The architecture, engineering and design of the project using Bullseye products are the responsibility of the project's design professional. All systems must comply with local building codes and standards. This detail is for general information and guidance only, and Bullseye Wall Technology, Inc, specifically disclaims any liability for the use of this detail and for the architecture, design, engineering or workmanship of any project. The project design professional determines, in its sole discretion, whether this detail or a functional equivalent alternative is best suited for the project. Use of a functionally equivalent detail does not violate Bullseye's warranty. This detail is subject to change without notice. Contact Bullseye to insure you have the most recent version.

Bullseye Wall Technology,  
Inc  
145 Kelli Clark Court  
Cartersville, GA 30121  
P: 770.974.0766  
F: 770.974.2974

**BULLSEYE**  
WALL TECHNOLOGY, INC.

WINDOW - METAL FRAMED, EXPOSED  
SILL PAN  
WINDOW SILL & JAMB DETAIL

SCALE: NONE

DRAWN: AUGUST 6TH, 2008  
BY: K ALEXANDER

BULLSEYE WINDOW SILL & JAMB DETAIL 1.00